

# Evolux Ruber Complete shower Kit

## Description

Shower system with a trimmable grate to adapt to any shower size and shape, ideal for building site-made shower trays for domestic and/or communal use. It includes integrated waterproofing factory-mounted, consisting of a WATER-STOP waterproof membrane piece.

## Features

Stainless steel structure  
High load resistance  
Waterproofing included  
High drainage capacity  
Wide range of models  
Easy installation  
Effective cleaning  
10-year warranty

## Technical data

Stainless steel  
PVD and textured finishes

## Manufacturer

Estil Guru S.L.U

P.I. El Pla C/ Telers, 22 - Apdo. 584, 46870, Ontinyent,  
Valencia, SPAIN | [www.estilguru.com](http://www.estilguru.com) | [guru@estilguru.com](mailto:guru@estilguru.com)  
Tel. 0034 96 291 45 11 | Fax. 0034 96 236 90 10

## Evolux Lisa



Ruber H50	Ruber H28	Description	Finish	Size (cm)	W-S membrane
IE41040	IE41040R	Lisa	●	40	2 x 2 · 4 m <sup>2</sup>
IE41050	IE41050R	Lisa	●	50	2 x 2 · 4 m <sup>2</sup>
IE41000	IE41000R	Lisa	●	60	2 x 2 · 4 m <sup>2</sup>
IE41001	IE41001R	Lisa	●	70	2 x 2 · 4 m <sup>2</sup>
IE41002	IE41002R	Lisa	●	80	2 x 2 · 4 m <sup>2</sup>
IE41003	IE41003R	Lisa	●	90	2 x 2 · 4 m <sup>2</sup>
IE41004	IE41004R	Lisa	●	100	2 x 2 · 4 m <sup>2</sup>
IE41005	IE41005R	Lisa	●	120	2 x 2 · 4 m <sup>2</sup>
IE41150	IE41150R	Lisa	●	150	2 x 2 · 4 m <sup>2</sup>
IE41180	IE41180R	Lisa	●	180	2 x 2 · 4 m <sup>2</sup>

# Evolux Ruber Complete shower Kit

## Evolux Plus



Ruber H50	Ruber H28	Description	Finish	Size (cm)	W-S membrane
IE42000	IE42000R	Plus	●	60	2 x 2 · 4 m <sup>2</sup>
IE42001	IE42001R	Plus	●	70	2 x 2 · 4 m <sup>2</sup>
IE42002	IE42002R	Plus	●	80	2 x 2 · 4 m <sup>2</sup>
IE42003	IE42003R	Plus	●	90	2 x 2 · 4 m <sup>2</sup>
IE42004	IE42004R	Plus	●	100	2 x 2 · 4 m <sup>2</sup>
IE42005	IE42005R	Plus	●	120	2 x 2 · 4 m <sup>2</sup>
IE42150	IE42150R	Plus	●	150	2 x 2 · 4 m <sup>2</sup>
IE42180	IE42180R	Plus	●	180	2 x 2 · 4 m <sup>2</sup>

## Evolux Lisa Dark



Ruber H50	Ruber H28	Description	Finish	Size (cm)	W-S membrane
IE51000	IE51000R	Lisa Dark	●	60	2 x 2 · 4 m <sup>2</sup>
IE51001	IE51001R	Lisa Dark	●	70	2 x 2 · 4 m <sup>2</sup>
IE51002	IE51002R	Lisa Dark	●	80	2 x 2 · 4 m <sup>2</sup>
IE51003	IE51003R	Lisa Dark	●	90	2 x 2 · 4 m <sup>2</sup>
IE51004	IE51004R	Lisa Dark	●	100	2 x 2 · 4 m <sup>2</sup>
IE51005	IE51005R	Lisa Dark	●	120	2 x 2 · 4 m <sup>2</sup>
IE51150	IE51150R	Lisa Dark	●	150	2 x 2 · 4 m <sup>2</sup>
IE51180	IE51180R	Lisa Dark	●	180	2 x 2 · 4 m <sup>2</sup>

## Evolux Lisa Gold



Ruber H50	Ruber H28	Description	Finish	Size (cm)	W-S membrane
IE61000	IE61000R	Lisa Gold	●	60	2 x 2 · 4 m <sup>2</sup>
IE61001	IE61001R	Lisa Gold	●	70	2 x 2 · 4 m <sup>2</sup>
IE61002	IE61002R	Lisa Gold	●	80	2 x 2 · 4 m <sup>2</sup>
IE61003	IE61003R	Lisa Gold	●	90	2 x 2 · 4 m <sup>2</sup>

# Evolux Ruber Complete shower Kit

## Evolux Lisa Antivandal



Ruber H50	Ruber H28	Description	Finish	Size (cm)	W-S membrane
IE41701	IE41701R	Lisa Antivandal		70	2 x 2 · 4 m <sup>2</sup>
IE41702	IE41702R	Lisa Antivandal		80	2 x 2 · 4 m <sup>2</sup>
IE41703	IE41703R	Lisa Antivandal		90	2 x 2 · 4 m <sup>2</sup>

## Evolux Lisa Cristal



Ruber H50	Ruber H28	Description	Finish	Size (cm)	W-S membrane
IE49001	IE49001R	Lisa Cristal		70	2 x 2 · 4 m <sup>2</sup>
IE49002	IE49002R	Lisa Cristal		80	2 x 2 · 4 m <sup>2</sup>
IE49003	IE49003R	Lisa Cristal		90	2 x 2 · 4 m <sup>2</sup>

## Evolux Puntual



Ruber H50	Ruber H28	Description	Finish	Size (cm)	W-S membrane
IE41008	IE41008R	Lisa		11,6 x 11,6	1,5 x 2 · 3 m <sup>2</sup>
IE41009	IE41009R	Lisa		15 x 30	1,5 x 2 · 3 m <sup>2</sup>
IE41708	IE41708R	Lisa Antivandal.		11,6 x 11,6	1,5 x 2 · 3 m <sup>2</sup>
IE42008	IE42008R	Plus		11,6 x 11,6	1,5 x 2 · 3 m <sup>2</sup>
IE42009	IE42009R	Plus		15 x 30	1,5 x 2 · 3 m <sup>2</sup>
IE42708	IE42708R	Plus Antivandal.		11,6 x 11,6	1,5 x 2 · 3 m <sup>2</sup>
IE51008	IE51008R	Lisa Dark		11,6 x 11,6	1,5 x 2 · 3 m <sup>2</sup>
IE51009	IE51009R	Lisa Dark		11,6 x 11,6	1,5 x 2 · 3 m <sup>2</sup>
IE49009	IE49009R	Cristal		15 x 30	1,5 x 2 · 3 m <sup>2</sup>

# Evolux Ruber Complete shower Kit

## Test table

Features	Method	Requirement	Unit	Value
	EN 1253-1	EN 1253-1		
Drainage flow rate	Article 5.9.1	Article 4.8	l/s	>0.5
RUBER H50 water seal height (hydraulic seal)	Article 5.3.1	Article 4.2.2	mm	50
RUBER H28 water seal height (hydraulic seal)	Article 5.3.1	Article 4.2.2	mm	28
Water seal pressure resistance	Article 5.3.2	Article 4.1.6	Pa	>400
Self-cleaning capacity	Article 5.4.2	Article 4.2.2	-	Pass
Clog prevention	Article 5.4.3	Article 4.2.3	-	Pass
Thermal behaviour	Article 5.5	Article 4.5	-	Class A
Watertightness	Article 5.8.2	Article 4.6.2	-	Pass
Watertightness of extensions	Article 5.8.2	Article 4.6.3	-	Pass
Odour tightness	Article 5.8.1	Article 4.6.1	-	Pass
Watertightness of the drain used with waterproofing membrane	Article 5.8.3	Article 4.7.3.4	-	Pass
Mechanical strength of the factory-mounted flange / waterproof membrane connection	Article 5.7.3	Article 4.7.3.4	N	>100
Load resistance	Article 5.6	Article 4.7.1	-	Class K3
Openings in the gratings (dimensions)	Article 5.1	Article 4.1.3	mm	<8
Appearance	-	Article 4.1.2	-	Pass
Materials	-	Article 4.4	-	Pass

## Features

- Allows the trap to be bypassed if there is an external trapped gully in the drainage network.
- Secondary drainage with a non-return system to remove infiltration water.
- Total installation height RUBER H50 (flush with grate), including flooring + adhesive: minimum 90 mm / maximum 110 mm.
- Total installation height RUBER H28 (flush with grate), including flooring + adhesive: minimum 70 mm / maximum 90 mm.
- Flooring thickness when installed at minimum height: 7 mm total including installation adhesive.
- Maximum flooring + tile adhesive thickness: 23 mm.
- Push-fit connections between the different elements of the drainage system.
- Decoupling by elastic seals allowing slight movement between the parts.
- 360° adjustable horizontal outlet.
- Includes a protective cap for the drain opening during installation.

Warning: To avoid the risk of blockage caused by a double trap, before starting the installation it is very important to check whether a trapped drain is required or whether the system will be installed with an external trapped gully.

The system body is designed as a trapped drain, but the water seal can be bypassed. If necessary, follow the installation procedure instructions. The trap cannot be bypassed after installation, nor replaced. It is advisable to keep the trapped drain and connect it directly to the waste pipe without passing through the external trapped gully.

# Evolux Ruber Complete shower Kit

## Notes and observations

The nominal flow rate at 3 bar pressure of most shower heads is between 9 and 20 litres per minute (between 0.15 and 0.35 l/s). For shower drains, the minimum drainage flow rate required by the standard is 0.40 l/s (24 litres per minute) for a single shower head. This minimum value does not apply to multi-jet showers or multiple-shower installations with a single drain.

For values relating to the characteristics of the WATER-STOP membrane, refer to its technical data sheet.

The minimum installation height mentioned is the lowest possible due to the drain dimensions. In each installation, the actual effective minimum height will be that which allows the waste pipe to be laid with the proper slope towards the drainage network, plus the thickness of the flooring and its installation adhesive.

The waste pipe must have a minimum slope of 1.5% towards the drainage network (the level difference should be 1 to 2 cm per linear metre). The length of that section should not exceed 1 m.

**To move the drain:** If the position of the drainage point requires the drain to be moved, leaving excess membrane on one side and insufficient membrane on the other, the excess may be cut while respecting the 10 cm upturn on walls and bonded where required, making the joint between membranes with an overlap 5 to 10 cm wide and in the direction of the slope.

**To bond overlap joints:** In site-built showers and in small interior non-floodable areas, the same C2 tile adhesive used for the installation may be used. If maximum watertightness is required, make the joints with EASEAL polymer cement or W-S MASTIC adhesive sealant.

**To bond WATER-STOP to the substrate:** On traditional construction substrates, use C2 tile adhesive. For plaster, existing ceramic tiles and other substrates, verify that the selected adhesive is suitable for the substrate. Apply following the manufacturer's instructions.

**To bond finishes to WATER-STOP:** For ceramic floor tiles or similar finishes, use C2 tile adhesive. For wood, textiles and others, use an adhesive suitable for the finish and compatible with humidity. Apply following the manufacturer's instructions. More detailed information can be found in the ROOF INSTALLATION GUIDE.

**To complete the waterproof protection:** To build a shower free from damp caused by infiltration and condensation, installing protection on the floor alone is not enough. The walls must also be protected up to 2 m in height. Use the WATER-STOP membrane and its accessories. If this is not possible, we recommend protecting at least the wall in the area of the water outlets down to the floor.

The data shown are for information purposes only and may be modified without prior notice. Tests deemed appropriate must be carried out to verify the suitability of the product for the intended use when this differs from what is stated here.

## Technical drawings

Linear channel

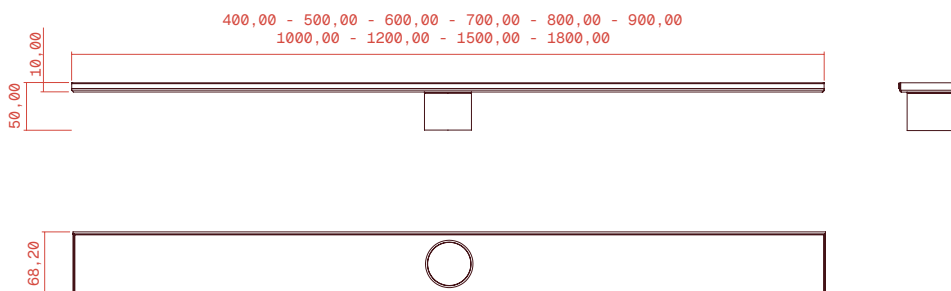

# Evolux Ruber Complete shower Kit

## Technical drawings

Lisa linear grate

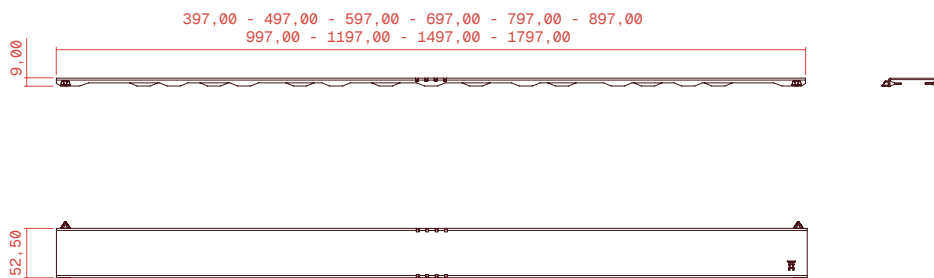

Plus linear grate

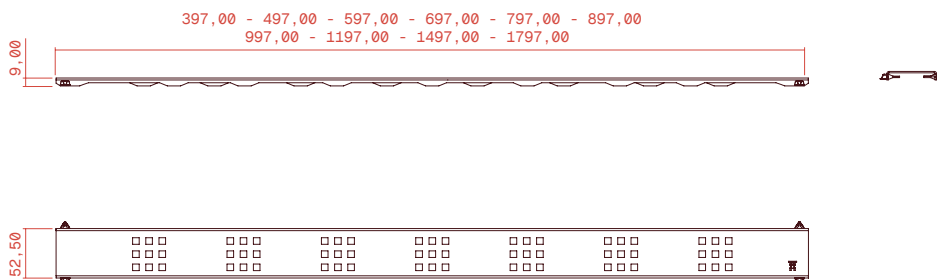

Anti-vandal linear channel

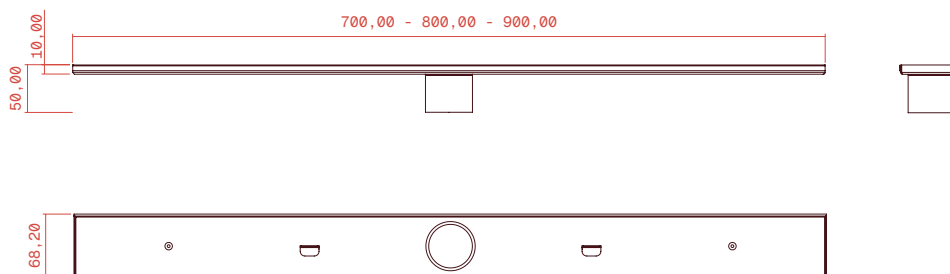

Anti-vandal linear grate

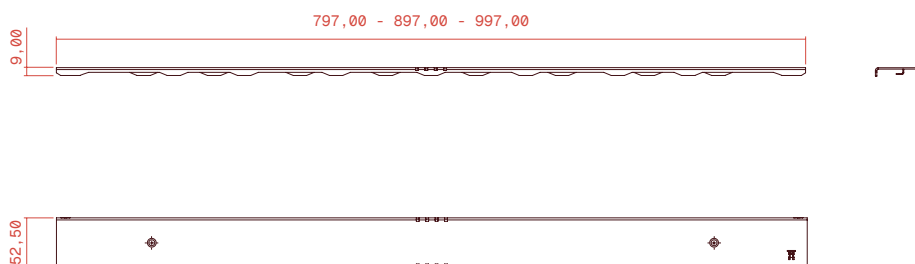

# Evolux Ruber Complete shower Kit

## Technical drawings

Channel 11,6 × 11,6

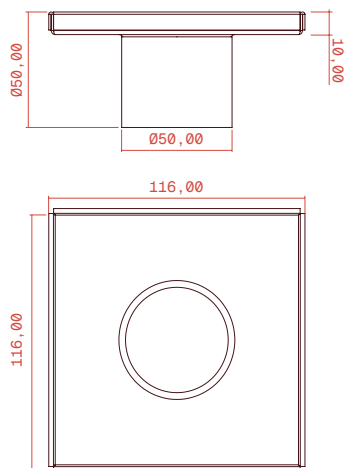

Antivandal channel  
11,6 × 11,6

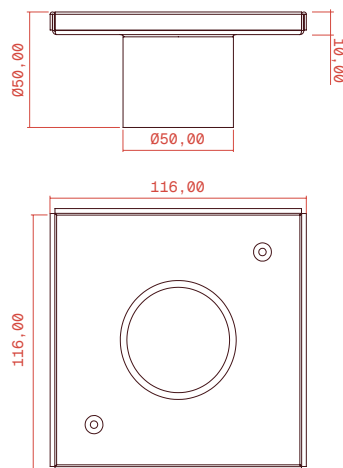

Lisa grate  
11,6 × 11,6

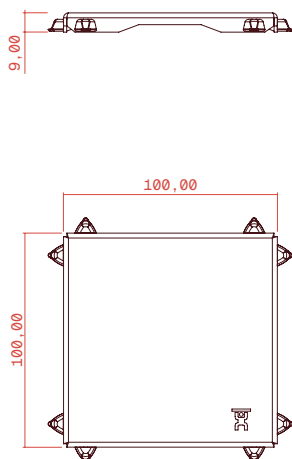

Grate Plus  
11,6 × 11,6

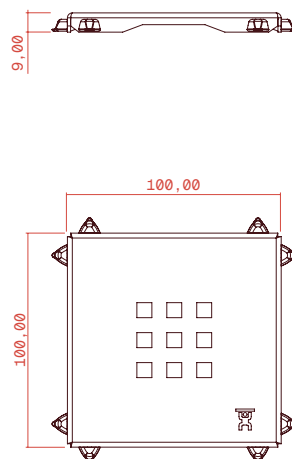

Antivandal Lisa grate  
11,6 × 11,6

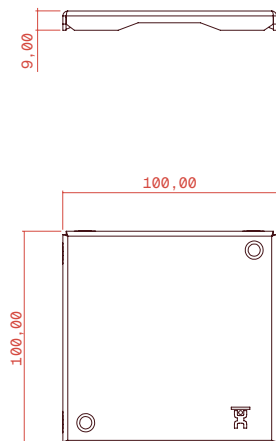

Antivandal Grate Plus  
11,6 × 11,6

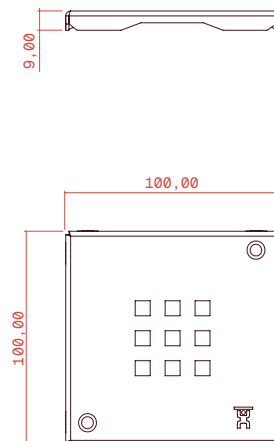

# Evolux Ruber Complete shower Kit

## Technical drawings

Channel  
15 x 30

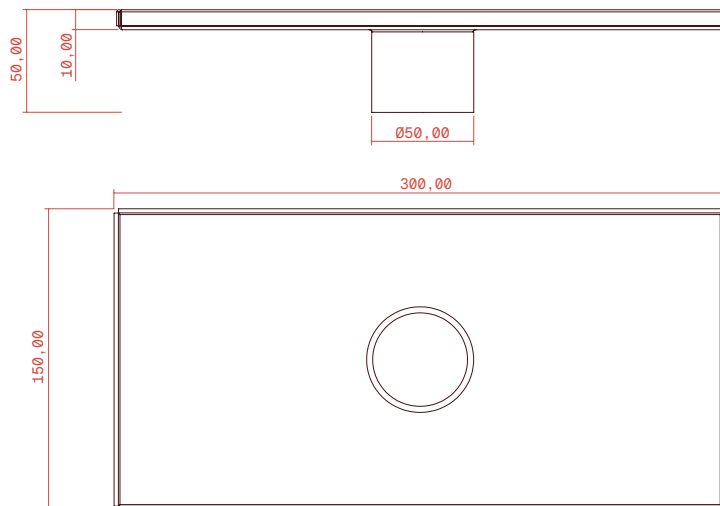

Lisa grate  
15 x 30

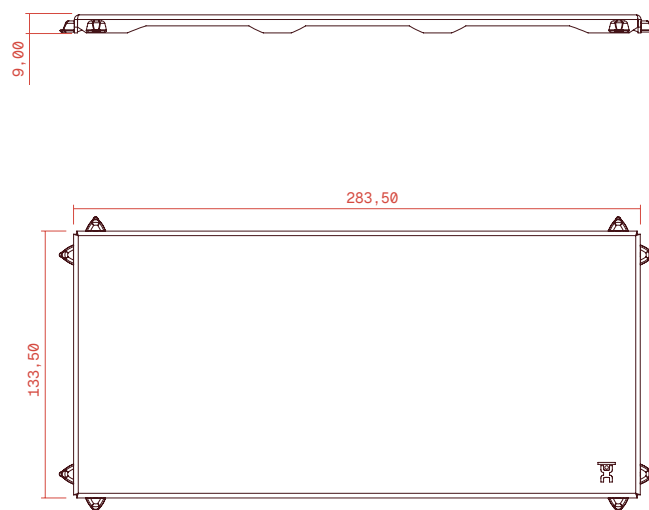

Grate Plus  
15 x 30

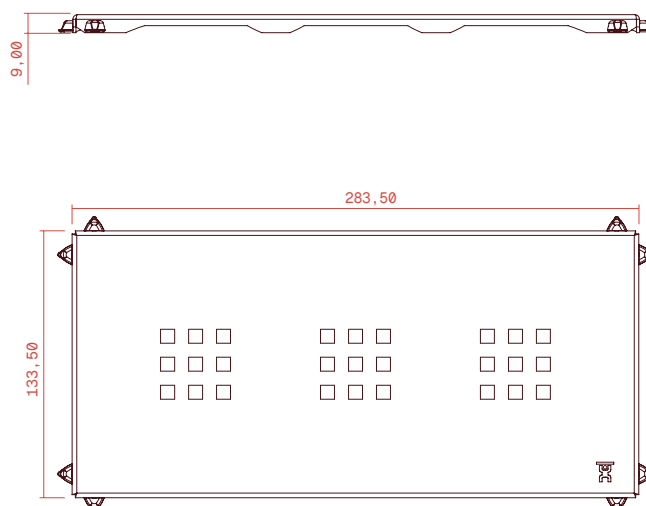

# Evolux Ruber Complete shower Kit

## Components

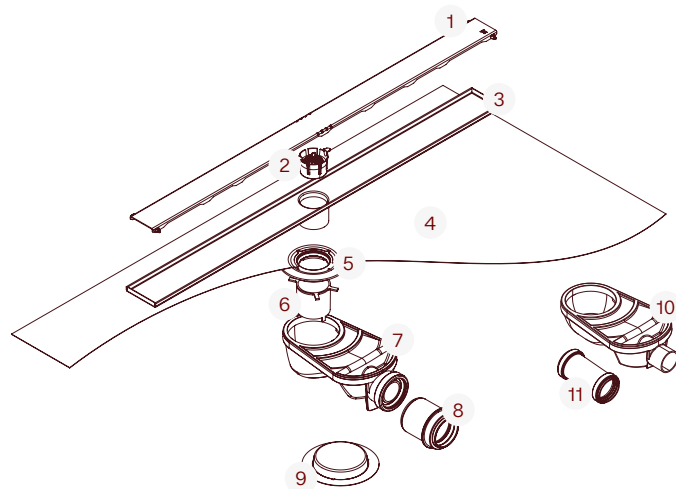
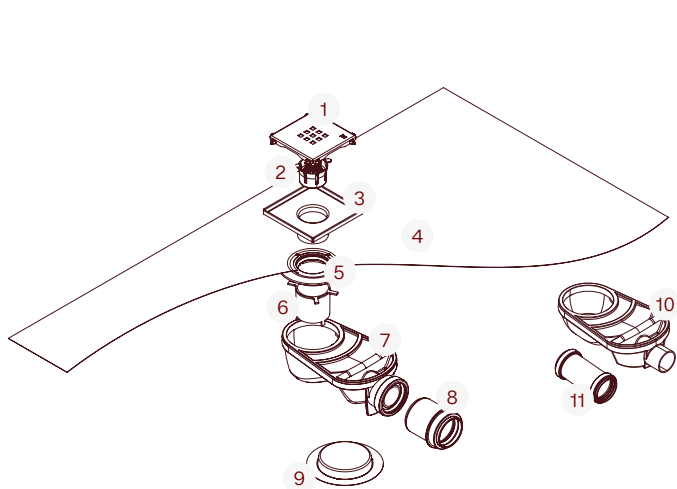

Part	Description	Material
1	Point grate	Stainless steel
2	Hair strainer	ABS
3	Linear channel	Stainless steel
4	WATER-STOP membrane	EVAC
5	Adapter	ABS
6	Ruber collar	ABS
7	Ruber H50 drain	ABS
8	Reducer *1	PP
9	Protective cover	PVC
10	Ruber H28 drain *2	ABS
11	Ø40 sleeve *2	PP

\*1 Included only with RUBER H50 | \*2 Included only in reduced kits

Part	Description	Material
1	Plain grate	Stainless steel
2	Hair strainer	ABS
3	Linear channel	Stainless steel
4	WATER-STOP membrane	EVAC
5	Adapter	ABS
6	Ruber collar	ABS
7	Ruber H50 drain	ABS
8	Reducer *1	PP
9	Protective cover	PVC
10	Ruber H28 drain *2	ABS
11	Ø40 sleeve *2	PP

\*1 Included only with RUBER H50 | \*2 Included only in reduced kits

# Evolux Ruber Complete shower Kit

## Installation section

### Ruber H50 - Outlet Ø50

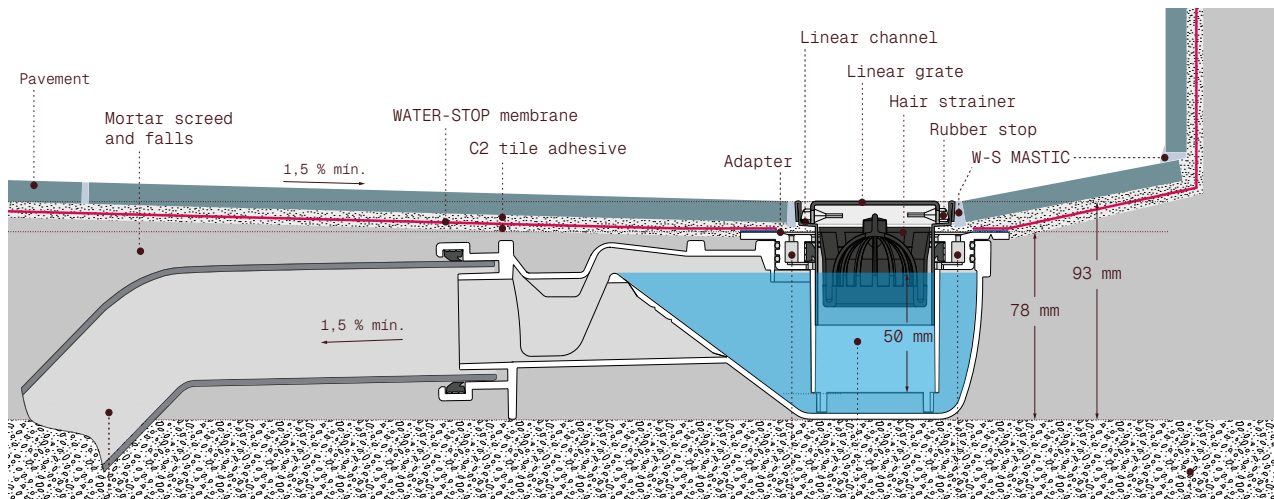

### Ruber H28 - Outlet Ø40

