

Evolux Microcemento

Complete shower Kit

Ruber Kit

Description Shower system with drain channel and siphonic drain, featuring factory-integrated, heat-bonded waterproofing made from a piece of WATER-STOP waterproof membrane. The grate is prepared for microcement installations.

Features	Reinforced structure Maximum strength Lightweight Waterproofing included High drainage capacity Easy installation Effective cleaning 10-year warranty	Technical data	Textured stainless steel channel Aluminum grate with textured coating Dovetail grooves - maximum grip Self-centering grate by means of rubber stops
-----------------	--	-----------------------	--

Manufacturer Estil Guru S.L.U

P.I. El Pla C/ Telers, 22 - Apdo. 584, 46870, Ontinyent,
Valencia, SPAIN | www.estilguru.com | guru@estilguru.com
Tel. 0034 96 291 45 11 | Fax. 0034 96 236 90 10

Evolux Microcemento



RUBER H50

Ref.	Description	Size (cm)	W-S membrane	H Siphon
IE47008	Evolux Microcemento	11,6 x 11,6 cm	1,5 x 2 m · 3 m ²	50 mm
IE47009	Evolux Microcemento	15 x 30 cm	1,5 x 2 m · 3 m ²	50 mm
IE47000	Evolux Microcemento	60 cm	2 x 2 · 4 m ²	50 mm
IE47001	Evolux Microcemento	70 cm	2 x 2 · 4 m ²	50 mm
IE47002	Evolux Microcemento	80 cm	2 x 2 · 4 m ²	50 mm
IE47003	Evolux Microcemento	90 cm	2 x 2 · 4 m ²	50 mm
IE47004	Evolux Microcemento	100 cm	2 x 2 · 4 m ²	50 mm
IE47005	Evolux Microcemento	120 cm	2 x 2 · 4 m ²	50 mm

Evolux Microcemento **Complete shower Kit**

Ruber Kit

RUBER H28

Ref.	Description	Size (cm)	W-S membrane	H Siphon
IE47008R	Evolux Microcemento	11,6 × 11,6 cm	1,5 × 2 m · 3 m ²	28 mm
IE47009R	Evolux Microcemento	15 × 30 cm	1,5 × 2 m · 3 m ²	28 mm
IE47000R	Evolux Microcemento	60 cm	2 × 2 · 4 m ²	28 mm
IE47001R	Evolux Microcemento	70 cm	2 × 2 · 4 m ²	28 mm
IE47002R	Evolux Microcemento	80 cm	2 × 2 · 4 m ²	28 mm
IE47003R	Evolux Microcemento	90 cm	2 × 2 · 4 m ²	28 mm
IE47004R	Evolux Microcemento	100 cm	2 × 2 · 4 m ²	28 mm
IE47005R	Evolux Microcemento	120 cm	2 × 2 · 4 m ²	28 mm

Evolux Microcemento Dark

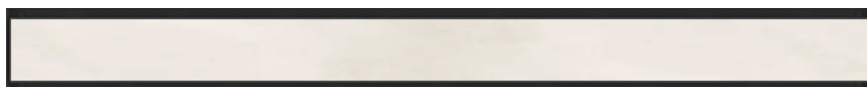

RUBER H50

Ref.	Description	Size (cm)	W-S membrane	H Siphon
IE57008	Evolux Microcemento Dark	11,6 × 11,6 cm	1,5 × 2 m · 3 m ²	50 mm
IE57009	Evolux Microcemento Dark	15 × 30 cm	1,5 × 2 m · 3 m ²	50 mm
IE57000	Evolux Microcemento Dark	60 cm	2 × 2 · 4 m ²	50 mm
IE57001	Evolux Microcemento Dark	70 cm	2 × 2 · 4 m ²	50 mm
IE57002	Evolux Microcemento Dark	80 cm	2 × 2 · 4 m ²	50 mm
IE57003	Evolux Microcemento Dark	90 cm	2 × 2 · 4 m ²	50 mm
IE57004	Evolux Microcemento Dark	100 cm	2 × 2 · 4 m ²	50 mm
IE57005	Evolux Microcemento Dark	120 cm	2 × 2 · 4 m ²	50 mm

Evolux Microcemento **Complete shower Kit**

Ruber Kit

Ref.	Description	Size (cm)	W-S membrane	H Siphon
IE57008R	Evolux Microcemento Dark	11,6 x 11,6 cm	1,5 x 2 m · 3 m ²	28 mm
IE57009R	Evolux Microcemento Dark	15 x 30 cm	1,5 x 2 m · 3 m ²	28 mm
IE57000R	Evolux Microcemento Dark	60 cm	2 x 2 · 4 m ²	28 mm
IE57001R	Evolux Microcemento Dark	70 cm 70 cm	2 x 2 · 4 m ²	28 mm
IE57002R	Evolux Microcemento Dark	80 cm	2 x 2 · 4 m ²	28 mm
IE57003R	Evolux Microcemento Dark	90 cm	2 x 2 · 4 m ²	28 mm
IE57004R	Evolux Microcemento Dark	100 cm	2 x 2 · 4 m ²	28 mm
IE57005R	Evolux Microcemento Dark	120 cm	2 x 2 · 4 m ²	28 mm

Evolux Microcemento Gold



RUBER H50

Ref.	Description	Size (cm)	W-S membrane	H Siphon
IE67008	Evolux Microcemento Gold	11,6 x 11,6 cm	1,5 x 2 m · 3 m ²	50 mm
IE67009	Evolux Microcemento Gold	15 x 30 cm	1,5 x 2 m · 3 m ²	50 mm
IE67000	Evolux Microcemento Gold	60 cm	2 x 2 · 4 m ²	50 mm
IE67001	Evolux Microcemento Gold	70 cm	2 x 2 · 4 m ²	50 mm
IE67002	Evolux Microcemento Gold	80 cm	2 x 2 · 4 m ²	50 mm
IE67003	Evolux Microcemento Gold	90 cm	2 x 2 · 4 m ²	50 mm

RUBER H28

Ref.	Description	Size (cm)	W-S membrane	H Siphon
IE67008R	Evolux Microcemento Gold	11,6 x 11,6 cm	1,5 x 2 m · 3 m ²	28 mm
IE67009R	Evolux Microcemento Gold	15 x 30 cm	1,5 x 2 m · 3 m ²	28 mm
IE67000R	Evolux Microcemento Gold	60 cm	2 x 2 · 4 m ²	28 mm
IE67001R	Evolux Microcemento Gold	70 cm	2 x 2 · 4 m ²	28 mm
IE67002R	Evolux Microcemento Gold	80 cm	2 x 2 · 4 m ²	28 mm
IE67003R	Evolux Microcemento Gold	90 cm	2 x 2 · 4 m ²	28 mm

Evolux Microcemento Complete shower Kit

Ruber Kit

Test table

Features	Method	Requirement	Unit	Value
	EN 1253-1	EN 1253-1		
Discharge flow rate	Article 5.9.1	Article 4.8	l/s	> 0,5
Water seal height RUBER H50 (hydraulic seal)	Article 5.3.1	Article 4.2.2	mm	50
Water seal height RUBER H28 (hydraulic seal)	Article 5.3.1	Article 4.2.2	mm	28
Water seal pressure resistance	Article 5.3.2	Article 4.1.6	Pa	> 400
Self-cleaning capacity	Article 5.4.2	Article 4.2.2	-	Pass
Blockage prevention	Article 5.4.3	Article 4.2.3	-	Pass
Thermal resistance	Article 5.5	Article 4.5	-	Class A
Watertightness	Article 5.8.2	Article 4.6.2	-	Pass
Extension watertightness	Article 5.8.2	Article 4.6.3	-	Pass
Odour tightness	Article 5.8.1	Article 4.6.1	-	Pass
Watertightness of drain used with waterproof membrane	Article 5.8.3	Article 4.7.3.4	-	Pass
Mechanical resistance of factory-mounted flange/membrane connection	Article 5.7.3	Article 4.7.3.4	N	> 100
Load resistance	Article 5.6	Article 4.7.1	-	Class K3
Grating openings (dimensions)	Article 5.1	Article 4.1.3	mm	< 8
Appearance	-	Article 4.1.2	-	Pass
Materials	-	Article 4.4	-	Pass

Features

- Allows the siphon to be bypassed if an external siphon trap exists in the drainage system.
- Secondary drainage with a non-return system to remove infiltration water.
- Total installation height of RUBER H50 including floor finish + adhesive: minimum 100 mm / maximum 120 mm.
- Total installation height of RUBER H28 including floor finish + adhesive: minimum 80 mm / maximum 100 mm.
- Accepts any floor finish thickness.
- Push-fit connections between the various components of the drainage system.
- RUBER H50 outlet: push-fit connection.
- RUBER H28 outlet: solvent-welded connection.
- Decoupling with elastic joints allowing slight movement between parts.
- 360° adjustable horizontal outlet.
- Includes protective cover for the drain opening during installation.

Warning: To avoid the risk of blockage due to a double trap, it is very important to check before installation whether a siphonic drain is needed, or if an external trap will be used.

The body of the system is designed as a siphonic drain, but the water seal can be disabled. If necessary, follow the instructions in the installation procedure.

The trap cannot be disabled or replaced after installation. It is recommended to keep the siphonic drain and connect directly to the drainage pipe without using an external trap.

Evolux Microcemento Complete shower Kit

Ruber Kit

Notes and observations

the nominal flow rate at 3 bar pressure of most shower heads ranges between 9 and 20 litres per minute (0.15 to 0.35 l/s). For shower drains, the minimum discharge flow rate required by standards is 0.40 l/s (24 litres per minute) for a single shower head. This minimum value does not apply in the case of multi-jet showers or multiple-shower installations with a single drain.

For information regarding the characteristics of the WATER-STOP membrane, please refer to its technical data sheet.

The minimum installation height mentioned is the lowest possible due to the dimensions of the drain. In each installation, the actual effective minimum height will be that which allows the drainage pipe to have the correct slope towards the evacuation network, plus the thickness of the flooring and its adhesive.

The drainage pipe must have a minimum slope of 1.5% towards the drainage network (the level difference should be 1 to 2 cm per linear metre). The length of this section should not exceed 1 m.

To relocate the drain: If the position of the drainage point requires relocating the drain causing excess membrane on one side and shortage on the other, the excess can be cut leaving 10 cm for wall upturns, and stuck where needed, joining membranes with an overlap of 5 to 10 cm wide, in the direction of the slope.

To glue overlap joints: For built-in showers and small non-floodable interior surfaces, the same type C2 tile adhesive used in the installation can be applied. For maximum waterproofing, joints should be sealed with EASEAL polymer cement or an adhesive sealant like W-S MASTIC.

To adhere water-stop to the substrate: On concrete, brick, or mortar rendering, use type C2 tile adhesive. For other substrates such as plaster, old ceramic, and others, verify that the chosen adhesive is suitable. Follow the manufacturer's instructions for application.

To adhere floor coverings to water-stop: For ceramic or similar flooring, use type C2 tile adhesive. For other coverings such as wood, textiles, and others, use an adhesive suitable for the covering and moisture-resistant. Follow the manufacturer's instructions for application.

To complete the waterproof protection: To achieve a shower free of humidity from infiltration and condensation, protection on the floor alone is insufficient. Walls must also be protected up to 2 m in height. Use the WATER-STOP membrane and its accessories. If this is not possible, at least protect the wall around water connections down to the floor.

The additional data provided are for informational purposes and may be changed without prior notice. It is strongly recommended to carry out any tests deemed necessary to verify the suitability of the product for the intended use when this differs from what is stated.

Components

System components	Composition	Dimensions	Unity
Channel with point grates	Stainless Steel AISI 304	116 × 116 × 10 150 × 300 × 10	mm
Channel with linear grates		600/700/800/900/1000/1200 × 69 × 10	mm
Clamping flange / connector	ABS	DN/DI 50	mm
RUBER H50 siphon body		HEIGHT 78	mm
RUBER H28 siphon body		HEIGHT 58	mm
Horizontal outlet RUBER H50 (push-fit connection)		DN/DI 50	mm
Horizontal outlet RUBER H28 (solvent weld connection)		DN/DI 40	mm
Reducer (only with RUBER H50)	PP	DN 50/40	mm
Waterproofing membrane *2	WATER-STOP	2 × 1,5 = (3 m ²) 2 × 2 = (4 m ²)	m
Sliding elastic seals / O-rings	SBR / NBR	-	

Evolux Microcemento Complete shower Kit

Ruber Kit

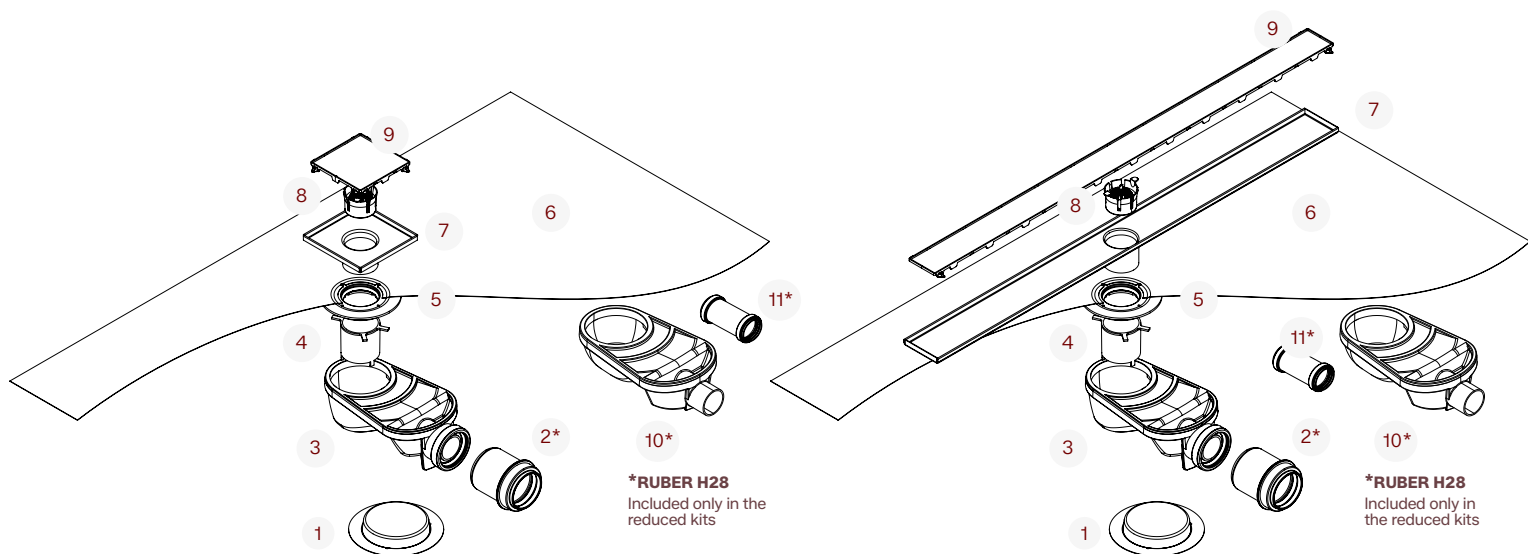

***RUBER H28**
Included only in the reduced kits

***RUBER H28**
Included only in the reduced kits

Piece	Denomination	Material
1	Protective cover	PVC
2	^{*1} Reducer	PP
3	Drain ruber H50	ABS
4	Ruber shower head	ABS
5	Adapter	ABS
6	Water-stop membrane	EVAC
7	Point channel	STAINLESS STEEL
8	Hair strainer	ABS
9	Point grate	STAINLESS STEEL
10	^{*2} Drain ruber H28	ABS
11	^{*2} Sleeve Ø40	PP

^{*1} Only included with RUBER H50

^{*2} Included only in the reduced kits

Pieza	Denomination	Material
1	Protective cover	PVC
2	^{*1} Reducer	PP
3	Drain ruber H50	ABS
4	Ruber shower head	ABS
5	Adapter	ABS
6	Water-stop membrane	EVAC
7	Linear channel	STAINLESS STEEL
8	Hair strainer	ABS
9	Linear grate	STAINLESS STEEL
10	^{*2} Drain ruber H28	ABS
11	^{*2} Sleeve Ø40	PP

^{*1} Only included with RUBER H50

^{*2} Included only in the reduced kits

Evolux Microcemento Complete shower Kit

Ruber Kit

Technical drawings (Point)

Microcemento 11,6 - Channel + grate - (Measures in mm)

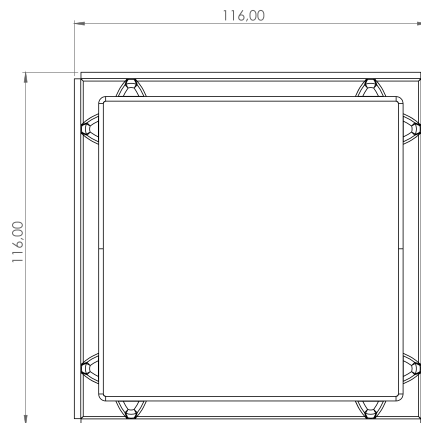
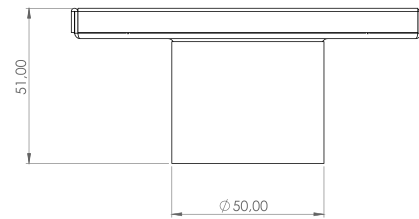

Evolux Microcemento Complete shower Kit

Ruber Kit

Technical drawings (Point)

Microcemento 11,6 (Channel)

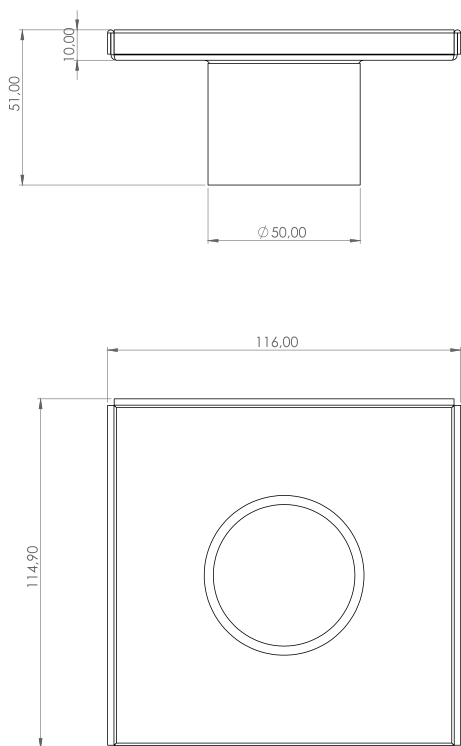

Microcemento 11,6 (Grate)

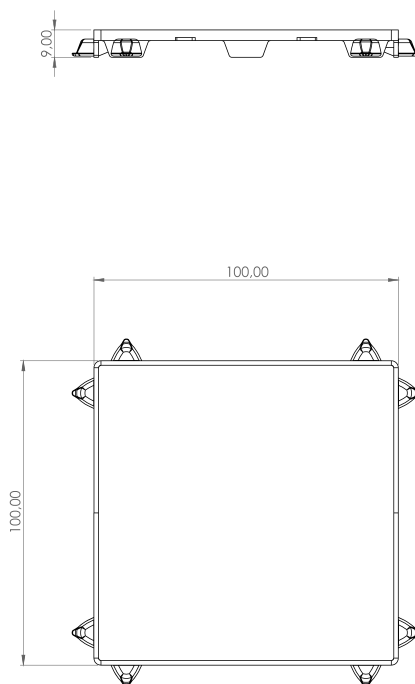

Evolux Microcemento Complete shower Kit

Ruber Kit

Technical drawings (Point)

Microcemento 15 x 30 (Channel + Grate)

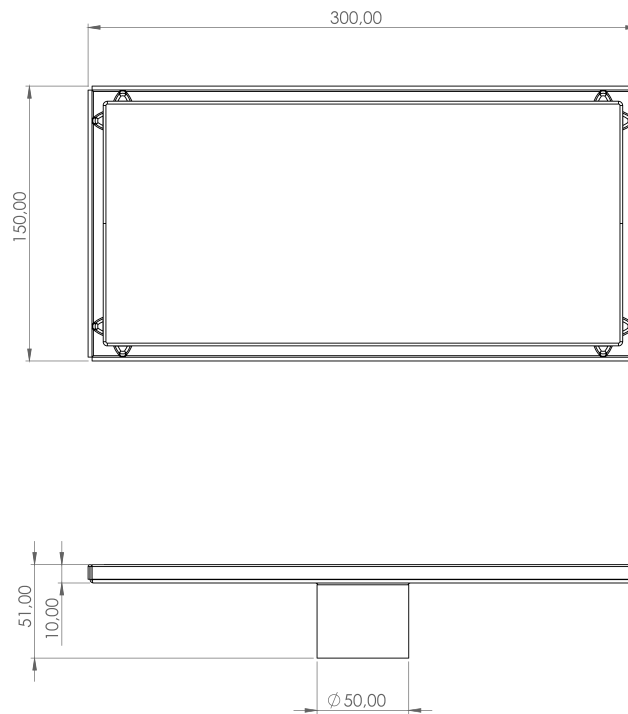

Microcemento 15 x 30 (Channel)

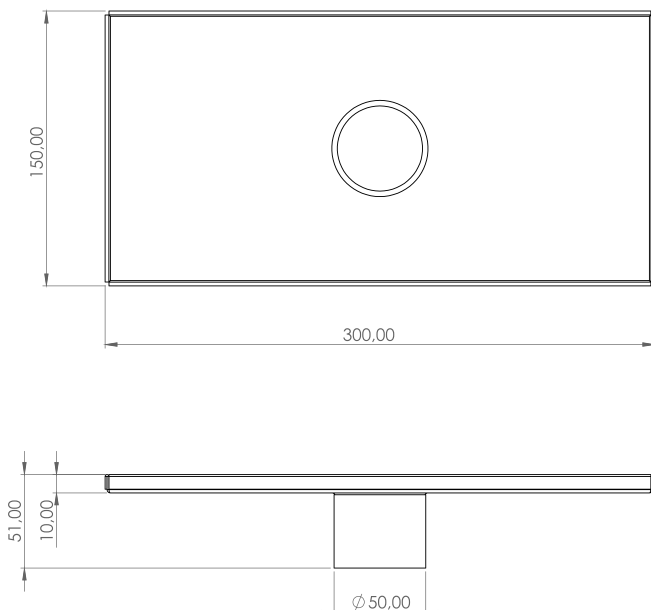

Microcemento 15 x 30 (Grate)

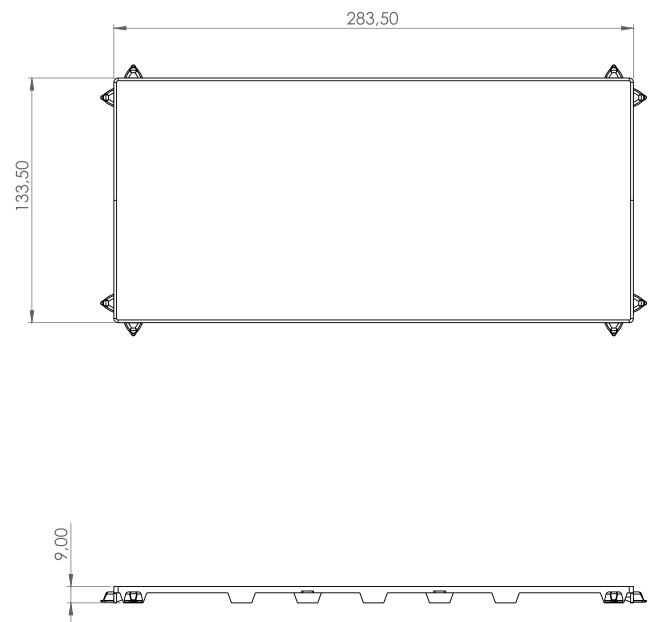

Evolux Microcemento Complete shower Kit

Ruber Kit

Planos técnicos (Linear)

Microcemento (Channel + grate)

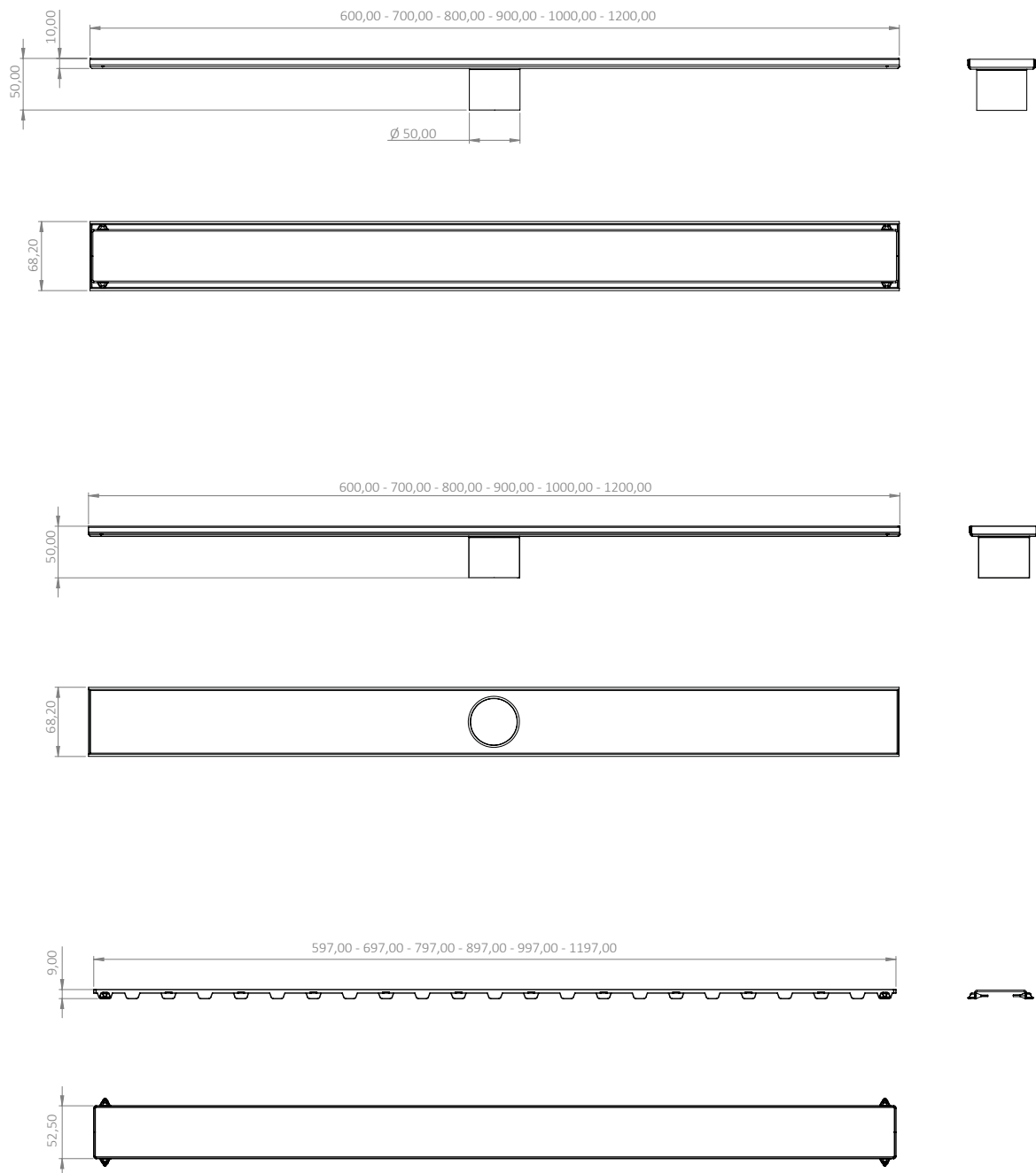

Evolux Microcemento Complete shower Kit

Ruber Kit

Installation section

RUBER H50 - Outlet Ø50

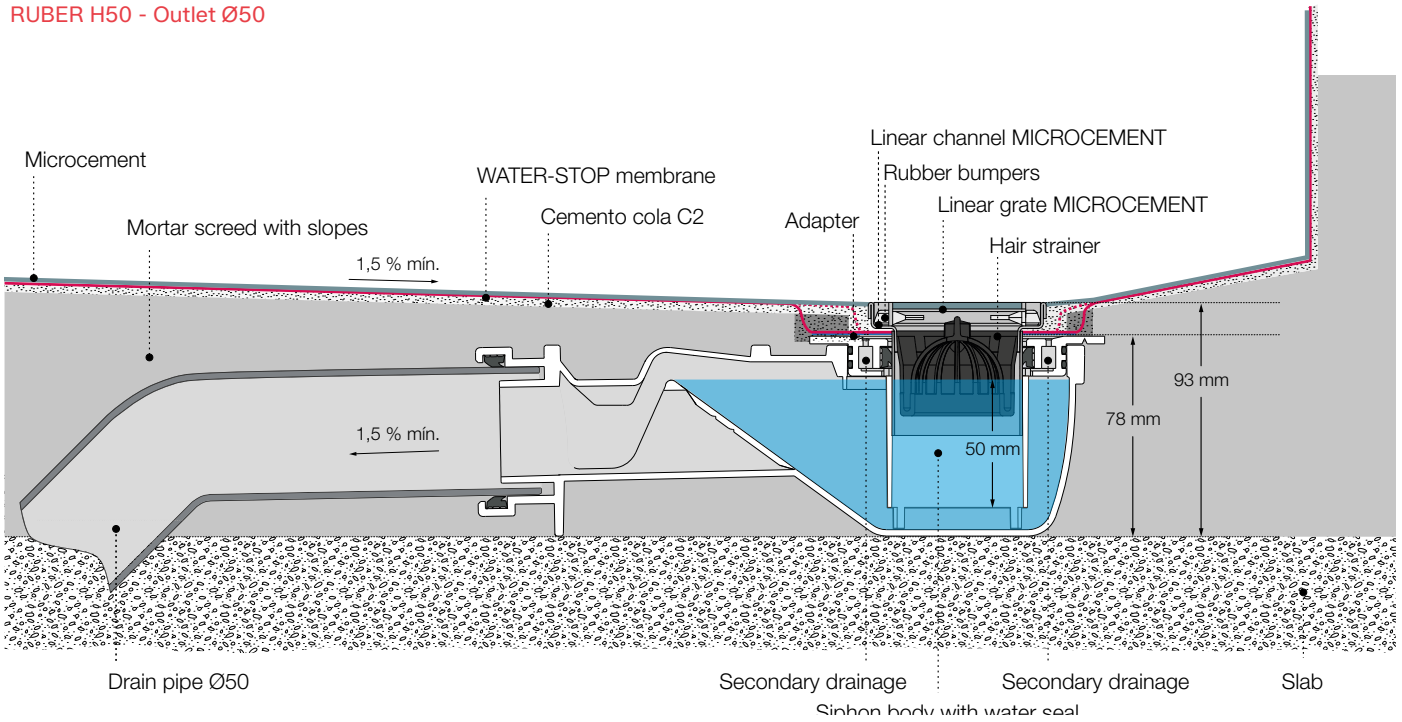

RUBER H28 - Outlet Ø40

